

VILLAGE OF WELLINGTON

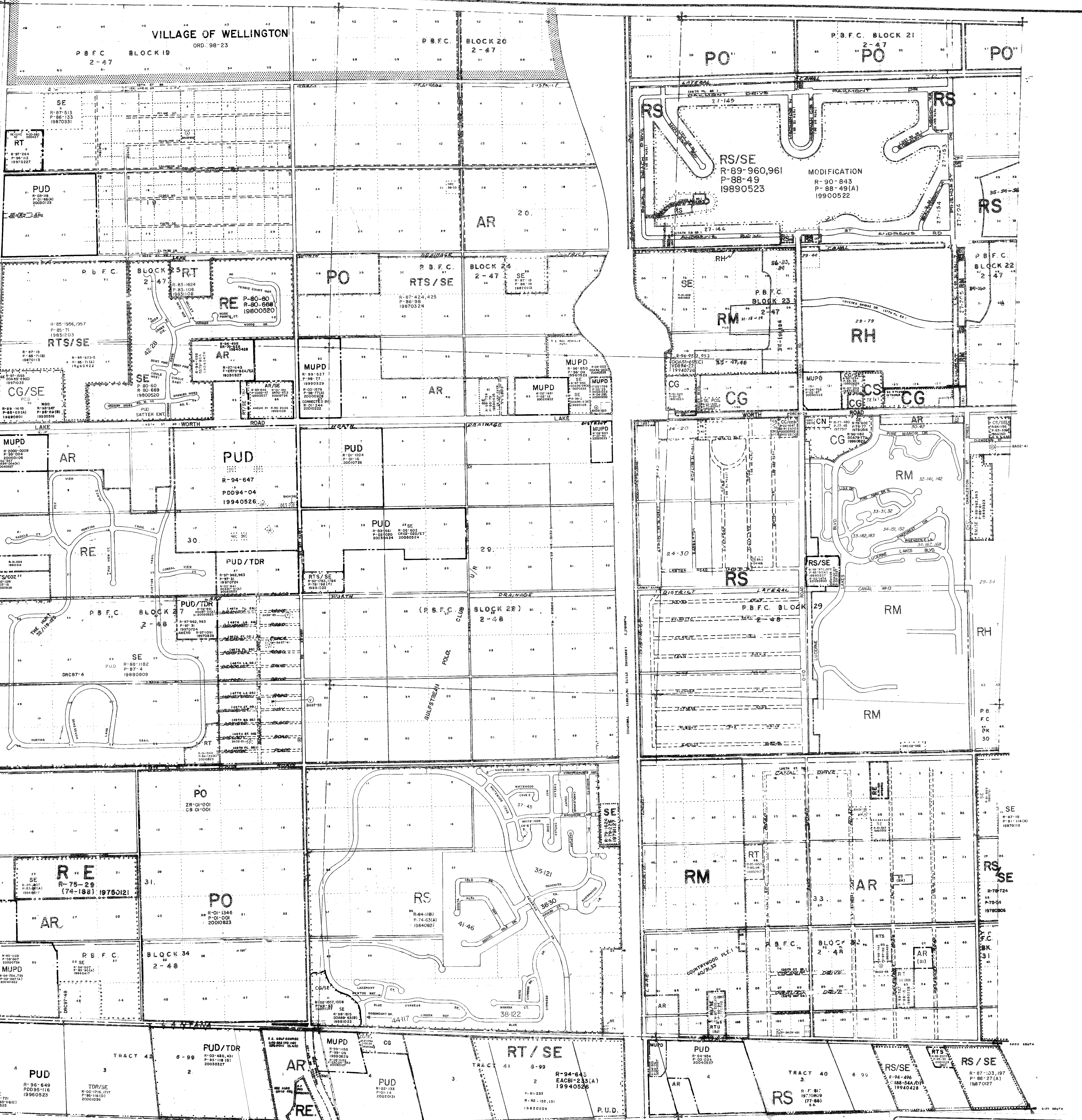

82-87-1004 (A) 8-25-1982	82-87-1005 (A) 8-25-1982	82-87-1006 (A) 8-25-1982	82-87-1007 (A) 8-25-1982	82-87-1008 (A) 8-25-1982	82-87-1009 (A) 8-25-1982	82-87-1010 (A) 8-25-1982
82-87-1011 (A) 8-25-1982	82-87-1012 (A) 8-25-1982	82-87-1013 (A) 8-25-1982	82-87-1014 (A) 8-25-1982	82-87-1015 (A) 8-25-1982	82-87-1016 (A) 8-25-1982	82-87-1017 (A) 8-25-1982
82-87-1018 (A) 8-25-1982	82-87-1019 (A) 8-25-1982	82-87-1020 (A) 8-25-1982	82-87-1021 (A) 8-25-1982	82-87-1022 (A) 8-25-1982	82-87-1023 (A) 8-25-1982	82-87-1024 (A) 8-25-1982

82-87-1025 (A) 8-25-1982	82-87-1026 (A) 8-25-1982	82-87-1027 (A) 8-25-1982	82-87-1028 (A) 8-25-1982	82-87-1029 (A) 8-25-1982	82-87-1030 (A) 8-25-1982	82-87-1031 (A) 8-25-1982
82-87-1032 (A) 8-25-1982	82-87-1033 (A) 8-25-1982	82-87-1034 (A) 8-25-1982	82-87-1035 (A) 8-25-1982	82-87-1036 (A) 8-25-1982	82-87-1037 (A) 8-25-1982	82-87-1038 (A) 8-25-1982
82-87-1039 (A) 8-25-1982	82-87-1040 (A) 8-25-1982	82-87-1041 (A) 8-25-1982	82-87-1042 (A) 8-25-1982	82-87-1043 (A) 8-25-1982	82-87-1044 (A) 8-25-1982	82-87-1045 (A) 8-25-1982

DISTRICT BOUNDARIES
CORPORATE BOUNDARIES

The zoning category for the property indicated on this sheet may not be consistent with the property's Future Land Use designation under the Palm Beach County Comprehensive Plan. Please contact the Palm Beach County Planning Division at 100 Australian Avenue, West Palm Beach, FL 33406, (561) 233-5500 to confirm the property's Future Land Use designation and other relevant Comprehensive Plan requirements.

PALM BEACH COUNTY, FLORIDA
Official Zoning District Map
Scale 1" = 600' approx Date May 1981
Quadrant 4-42 C Sheet No. 48